

ALORA INSIGHT

A mindful approach to water conservation,
crafted through intelligent design and
resilient landscaping.

**Every Drop Counts
at Alora**

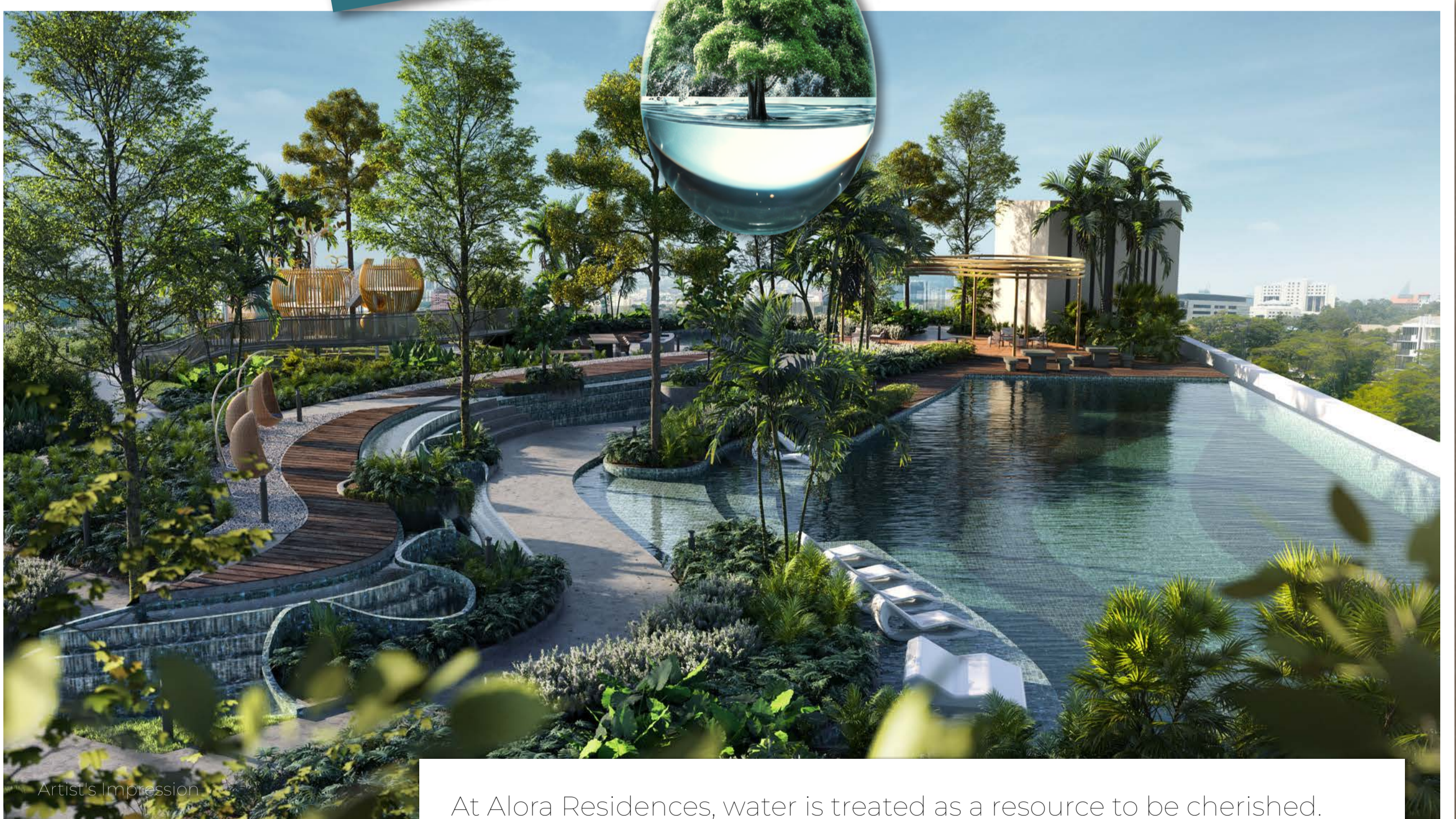

Artist's Impression

At Alora Residences, water is treated as a resource to be cherished. Through efficient fittings, rainwater harvesting, and drought-tolerant landscapes, the development embraces a design philosophy that protects nature while reducing residents' long-term costs. Here, thoughtful engineering creates a home where sustainability flows naturally into daily living.

A Landscape that Values Every Drop

Alora's water strategy begins with efficiency at the source. Within every residence, minimum 2-star WELS-rated sanitaryware and fittings carefully regulate water flow without compromising user comfort. These fittings, designed to deliver 4–6 litres per minute, provide smooth daily convenience while supporting more efficient use of potable water.

Outdoors, Alora adopts a regenerative approach through a rainwater harvesting system, which captures and redistributes rainfall across the development. This enables 88% of landscaped areas, including 90% of podium and ground-floor irrigation to be sustained by harvested water — dramatically lowering dependence on treated water while enhancing ecological resilience.

To complement this intelligent water cycle, Alora's landscape design integrates 67–70% drought-tolerant and tropical climate-adapted plant species. These selections flourish under natural conditions, requiring minimal irrigation while maintaining lush greenery throughout the year. The result is a masterfully composed landscape that stays vibrant with less water and offers effortless long-term maintenance.

Inside each unit, residents also enjoy the assurance of ready-to-drink water filter provisions, ensuring purity, convenience, and reduced reliance on bottled water. Together, these features reflect Alora's commitment to a holistic water-efficient lifestyle — one that balances elegance with environmental stewardship.

How it works:

INTELLIGENT CONSERVATION IN MOTION



MIN.
**2-Star
WELS**

Water-Efficient Fittings

These fittings manage flow rates without diminishing comfort, enabling households to achieve up to 60% water savings per year while reducing long-term utility costs.

01

**8m³
Storage**

Rainwater Harvesting

Collected rainwater irrigates landscaped spaces, ensuring sustainable greenery and reducing dependence on potable water.

This system supports 88% of landscaped areas, including 90% at podium and ground levels.



02

67–70%
Drought-Tolerant
Plants

Climate-Responsive Landscaping

Plants chosen for resilience require less water and maintenance, contributing to a more self-sustaining environment while lowering overall upkeep.

03

Purified Water at Home

Ready-to-drink filtered water enhances daily convenience while reducing plastic bottle usage and long-term household costs.

04



Benefits to Residents
**EFFORTLESSLY
SUSTAINABLE LIVING**

- ✓ Lower household water bills through efficient fittings
- ✓ A lush, low-maintenance environment supported by drought-tolerant landscaping
- ✓ Reduced reliance on treated water via rainwater harvesting
- ✓ Cleaner, safer water at home through water filtration system provision within the unit
- ✓ A more resilient and sustainable community experience

Did You Know?

With its integrated systems, Alora achieves up to 62% water savings across the development.

Deep-Dive Gox

**THE ELEGANCE OF
WATER-SENSITIVE
LANDSCAPE DESIGN**

By choosing resilient plant species and pairing them with harvested rainwater irrigation, Alora creates a landscape that thrives naturally. This approach reduces water consumption dramatically while preserving the beauty and serenity of the environment — demonstrating that sustainability and refinement can flourish together.

Eco Tip

Water your plants early in the morning or late evening to reduce evaporation and maximise absorption.

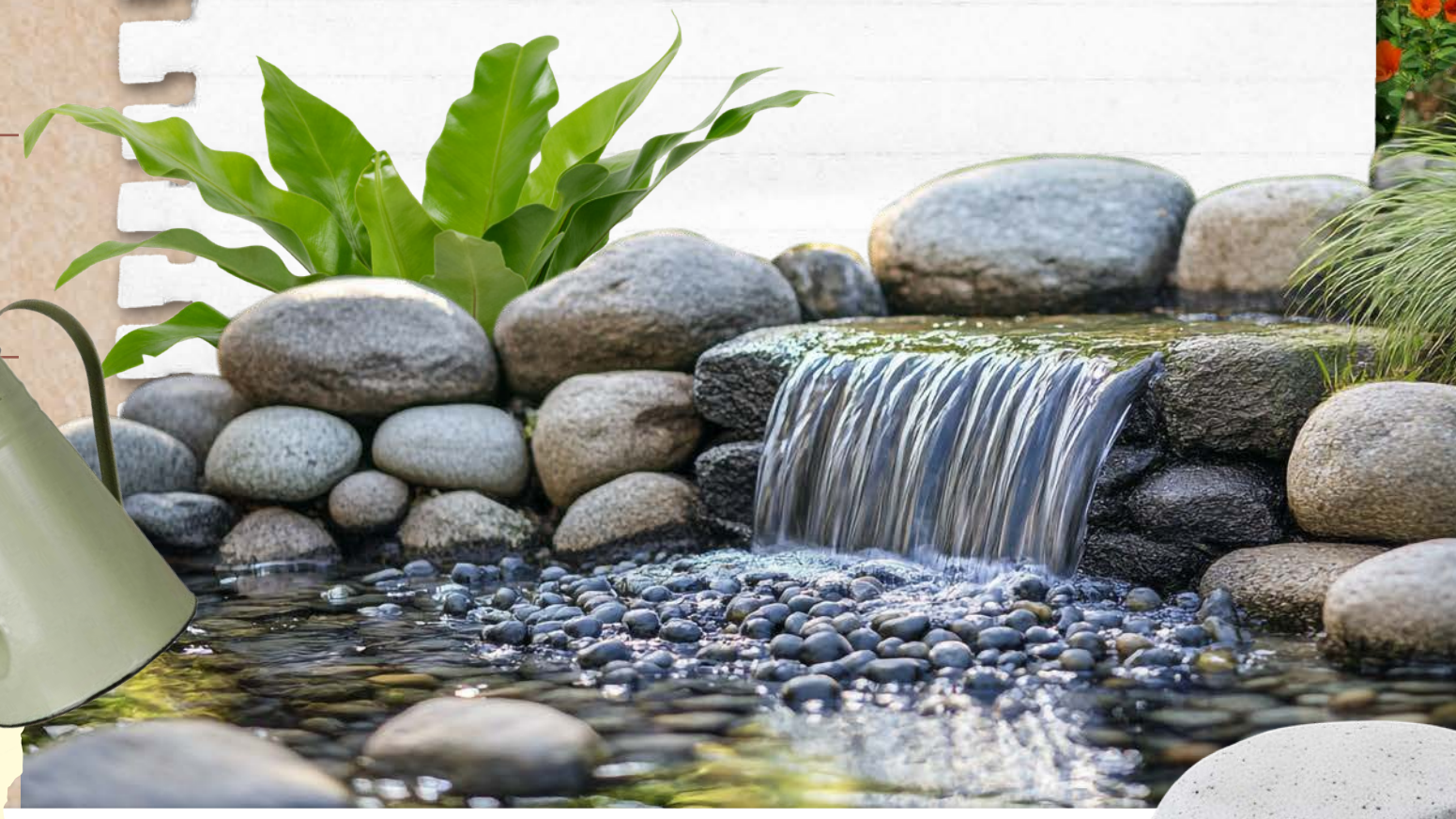

Artist's Impression

Site Progress Update

Infrastructure for water-efficient fittings, rainwater harvesting, and sustainable landscaping is progressing in alignment with Alora's green development objectives. These systems will continue to take shape as construction advances.

Visit Our Sales Gallery

Discover how water-wise living is seamlessly integrated into every detail of Alora.

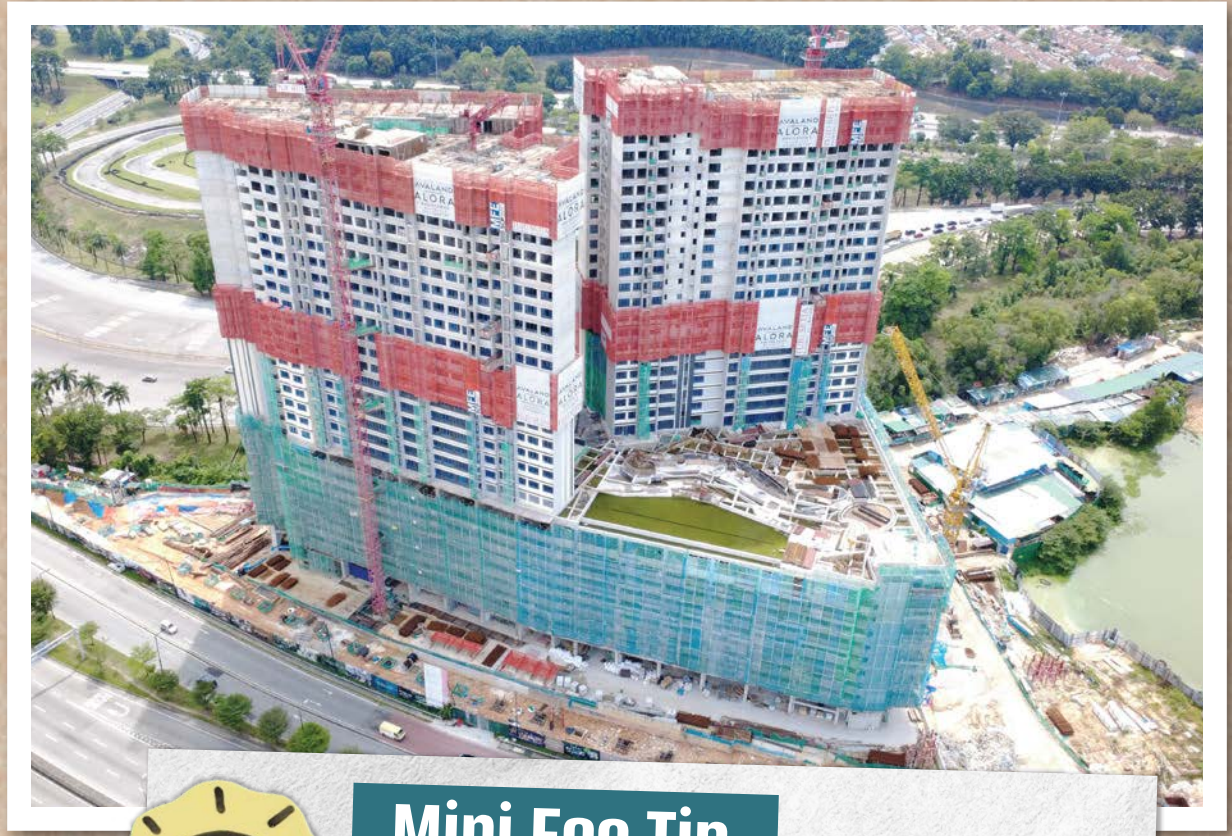

Mini Eco Tip

Fix minor leaks early — a single dripping tap can waste more than 20 litres of water daily.